

© Copyright (as noted below).  
 This drawing and all reproductions thereof are the property of Hill Foley Rossi & Associates, LLC (HFR). It is intended for the sole use of the project named herein. Reproduction without the written consent of HFR is unlawful. All copies are to be returned to HFR upon project completion.

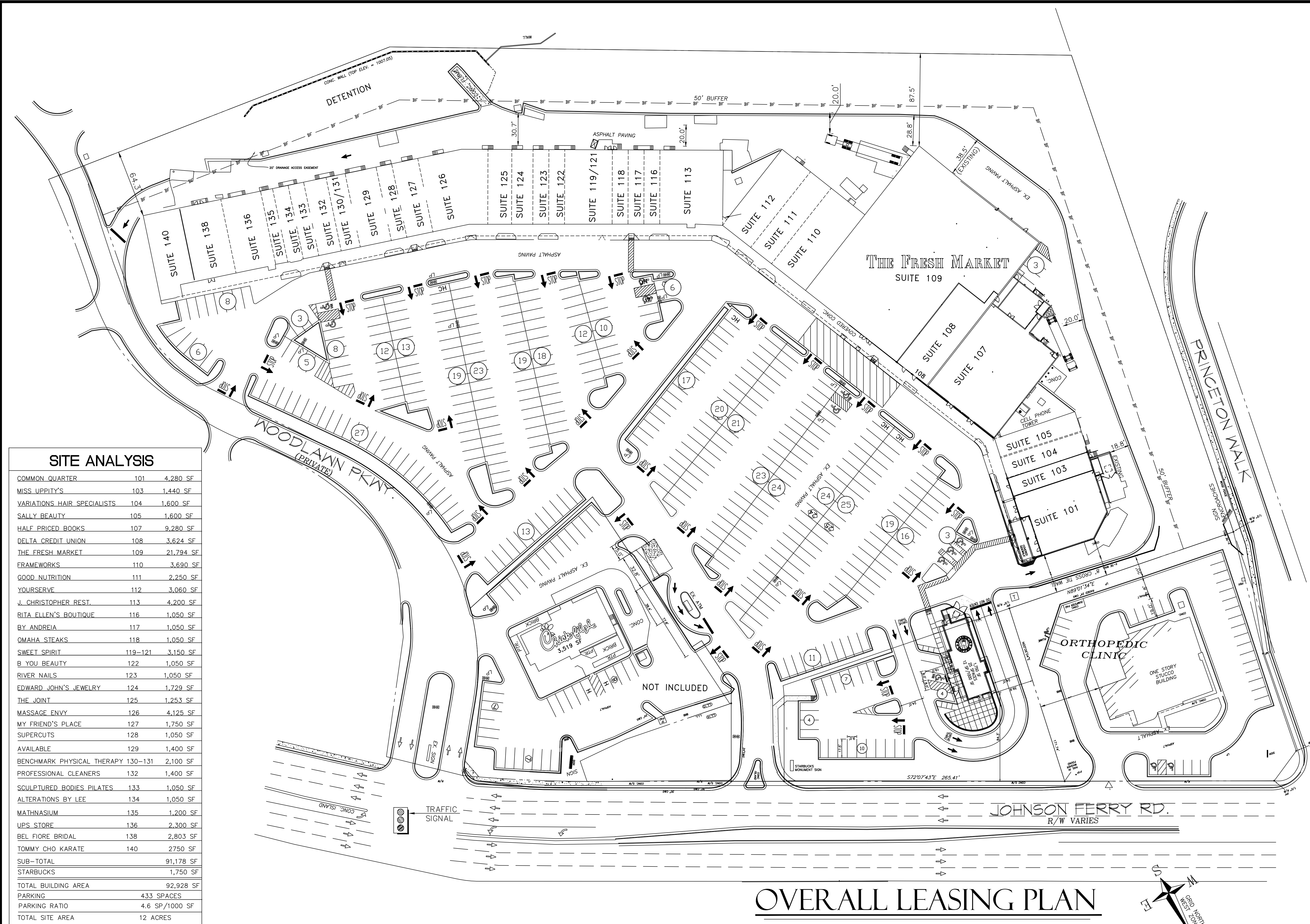

**SITE ANALYSIS**

COMMON QUARTER	101	4,280 SF
MISS UPPITY'S	103	1,440 SF
VARIATIONS HAIR SPECIALISTS	104	1,600 SF
SALLY BEAUTY	105	1,600 SF
HALF PRICED BOOKS	107	9,280 SF
DELTA CREDIT UNION	108	3,624 SF
THE FRESH MARKET	109	21,794 SF
FRAMEWORKS	110	3,690 SF
GOOD NUTRITION	111	2,250 SF
YOURSERVE	112	3,060 SF
J. CHRISTOPHER REST.	113	4,200 SF
RITA ELLEN'S BOUTIQUE	116	1,050 SF
BY ANDREA	117	1,050 SF
OMAHA STEAKS	118	1,050 SF
SWEET SPIRIT	119-121	3,150 SF
B YOU BEAUTY	122	1,050 SF
RIVER NAILS	123	1,050 SF
EDWARD JOHN'S JEWELRY	124	1,729 SF
THE JOINT	125	1,253 SF
MASSAGE ENVY	126	4,125 SF
MY FRIEND'S PLACE	127	1,750 SF
SUPERCUTS	128	1,050 SF
AVAILABLE	129	1,400 SF
BENCHMARK PHYSICAL THERAPY	130-131	2,100 SF
PROFESSIONAL CLEANERS	132	1,400 SF
SCULPTURED BODIES PILATES	133	1,050 SF
ALTERATIONS BY LEE	134	1,050 SF
MATHNASIUM	135	1,200 SF
UPS STORE	136	2,300 SF
BEL FIORE BRIDAL	138	2,803 SF
TOMMY CHO KARATE	140	2,750 SF
SUB-TOTAL		91,178 SF
STARBUCKS		1,750 SF
TOTAL BUILDING AREA		92,928 SF
PARKING		433 SPACES
PARKING RATIO		4.6 SP/1000 SF
TOTAL SITE AREA		12 ACRES

PARKING REQUIRED = 553 SPACES  
 (RESTAURANT=10 SP/1000 SF RETAIL=5 SP/1000 SF)

BUILDING AREAS HAVE NOT BEEN CALCULATED BY HILL FOLEY ROSSI, LLC. BUILDING AREAS HAVE BEEN BASED ON INFORMATION BY OTHERS.

**OVERALL LEASING PLAN**

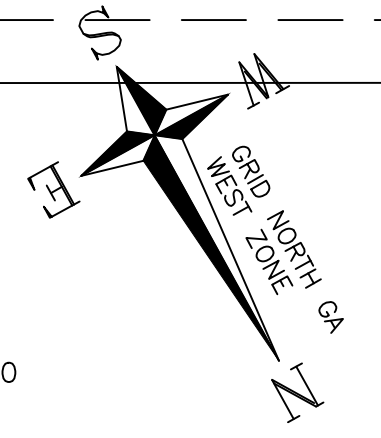
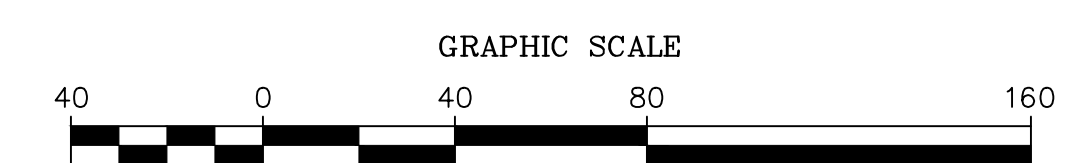

1	7.27.15	SUITE 129
MKI DATE SUBMITTAL/REVISION		

**WOODLAWN SQUARE**  
 1205 JOHNSON FERRY RD. NE  
 MARIETTA, GA 30068

LAND LOTS 13 & 14  
 1st DISTRICT, 2nd SECTION  
 COBB COUNTY, GA

FOR:  
**WOODLAWN SQUARE LP**  
 c/o RETAIL PLANNING CORPORATION  
 35 JOHNSON FERRY ROAD  
 MARIETTA, GA 30068  
 770-956-8383  
 678-385-1930 FAX

**OVERALL LEASING PLAN**

**CP.50**  
 HFR #01-155